

Concerning Compact Discs

Only compact discs bearing this mark can be used with this unit.



However, continued use of irregular shape CDs (heart-shape, octagonal, etc.) can damage the unit.

CD-R and CD-RW discs recorded with the audio CD format can be played back, though some may not be played back because of the disc characteristics or recording condition.

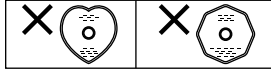

How to remove a disc from its case

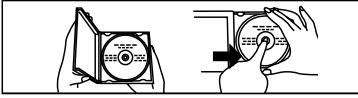

How to store the disc in its case



How to hold a disc

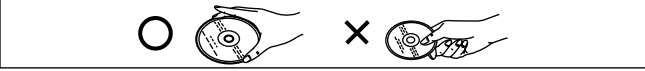

If the disc surface is dirty

Wipe it with a damp cloth and then wipe dry. Wipe from the center toward the outer edge.

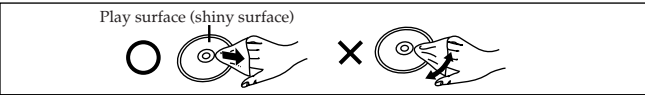

If moisture has formed on a disc

When moisture has formed because the disc was brought suddenly into a warm room from a cold environment, wipe off the moisture using a soft dry cloth.

When storing discs

Avoid locations which are

- Exposed to direct sunlight.
- Susceptible to high levels of humidity or dust.
- Directly exposed to heat from a heating appliance.
- On top of a car dashboard or near the rear window.

Handling precautions

- On the label side (the side with writing) Do not write anything using a pencil, ball-point pen, etc. Do not use adhesive paper or labels.
- On the disc (shiny) side Handle this side carefully to keep it free from fingerprints or scratches. Do not use record cleaners, solvents, etc.
- Do not attach labels or stickers to CDs.
- Do not use CDs with exposed adhesive from tape or left over peeled off stickers.
- Do not use scratch-proof protectors or covers other than those specified for use with this unit.

JVC

PORTABLE CD PLAYER XL-PR10BK

For Customer Use:

Enter below the Model No. and Serial No. which are located either on the rear, bottom or side of the player. Retain this information for future reference.

Model No. _____

Serial No. _____

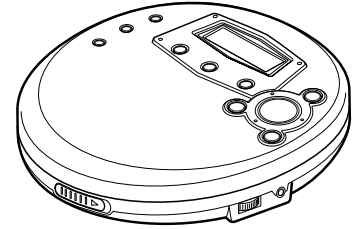

INSTRUCTIONS

Supplied Accessories

Check the packing carton for these accessories.

AC adaptor (AA-R4513)	1 pc.
Stereo headphones	1 pc.
Rechargeable Ni-Cd batteries (BN-R1211)	2 pcs.

Use numbers in parentheses when asking for replacement parts.

Thank you for purchasing this JVC product. Please read these instructions carefully before starting operation to be sure to obtain optimum performance and a longer service life from the unit.

LVT0992-002A [J]



0403SKMCREORI

©2003 VICTOR COMPANY OF JAPAN, LIMITED

Location of Controls

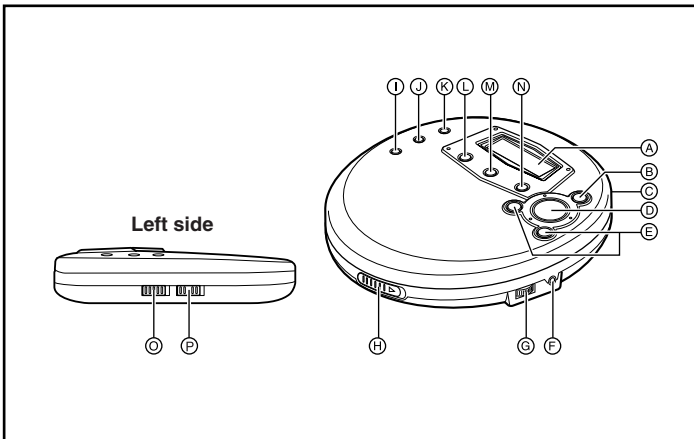

- Ⓐ Display
- Ⓑ Stop / power off button (■)
- Ⓒ DC IN jack (DC IN 4.5 V ⚡)
- Ⓓ Play / pause button (▶/⏸)
- Ⓔ Skip / search buttons (◀◀, ▶▶)
- Ⓕ Headphones jack (🔊)
- Ⓖ Volume control (VOLUME ▲)
- Ⓗ Lid open switch
- Ⓘ MODE/FM MODE button
- Ⓙ A.S.P. (Anti-Shock Protection EX) button
- Ⓚ PROGRAM button
- Ⓛ PRESET DOWN button
- Ⓜ FM/AM button
- Ⓝ PRESET UP button
- Ⓞ HOLD switch
- Ⓟ Hyper-Bass Sound switch (HBS)

Power Supply Preparations

Using rechargeable batteries (supplied)

Be sure to recharge the rechargeable batteries before using them.

Recharging procedure

1 Insert the rechargeable batteries.

Caution:

Do not forcibly open the battery lid too wide.

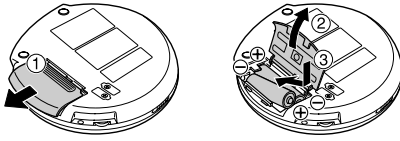

2 Connect the AC adaptor (supplied).

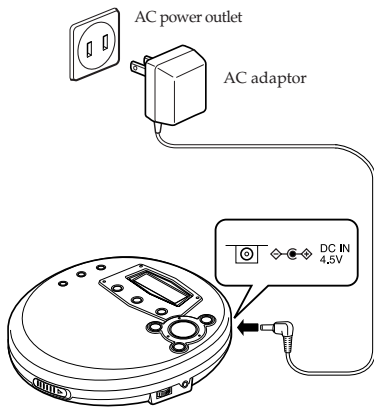

Recharging will be completed after 10 hours.

3 When recharging is complete, unplug the AC adaptor from the AC power outlet and the DC IN jack.

Notes:

- Rechargeable batteries have a service life of approximately 300 charge-discharge cycles. If the operating time on one full charge becomes noticeably shorter than it used to be, the batteries have reached the end of their service life and should be replaced.
- You can recharge the batteries only when the unit is turned off.
- The AC adaptor and rechargeable batteries may become warm while recharging is in progress. This is normal and is not a malfunction.

If the battery lid compartment comes loose

Slide the lid back into place horizontally.

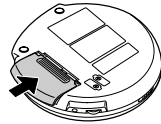

Removing batteries

Push up on the battery in the direction indicated by the arrow. Then lift it out.

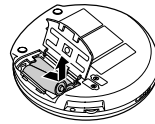

Using the AC adaptor (supplied)

Connect the AC adaptor.

Refer to "Using rechargeable batteries" for connection instructions.

Note:

Even if the unit is turned off, small power is consumed as long as the AC adaptor is connected to the AC power outlet.

Using dry-cell batteries (not supplied)

After disconnecting the AC adaptor, insert two "AA" (LR6) alkaline batteries.

The procedure for inserting and removing dry-cell batteries is identical to that for rechargeable batteries.

Battery indicator

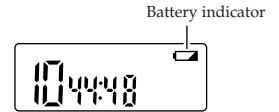

This indicator flashes on and off when the batteries are almost out of power. Power will be cut off a short while later.

Tip:

Turning off the Anti-Shock Protection will save the battery power more or less. For details, see "Anti-shock Protection" on page 6.

Preventing Accidental Operation (Hold mode)

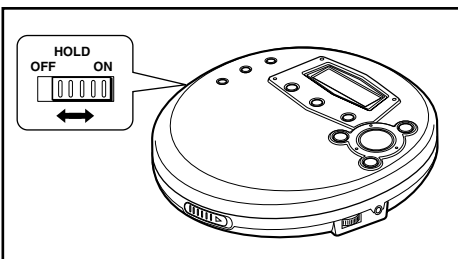

This function causes the unit to ignore accidental button presses.

Hold mode prevents the following:

- Powering on the unit accidentally (which can cause the batteries to go dead).
- Play or broadcast reception being cut off unexpectedly.

To use the Hold mode

- To prevent the unit from powering on accidentally, set the HOLD switch to the ON position, while the unit is turned off.
- To prevent the unit from unexpected operation during play, set the HOLD switch to the ON position after you starts playing the disc.

"HOLD"

When the unit is in Hold mode, "HOLD" lights as follows.

Power on : "HOLD" stays lit.

Power off : "HOLD" lights up for a few seconds when ►/II or FM/AM button is pressed.

To release the function

Set the HOLD switch to OFF position.

Note:

If the HOLD switch is set to the ON position, you cannot turn on the unit.

Precautions

Before using this unit, be sure to read the applicable items of the operating instructions and these safety-suggestions carefully. Afterwards keep them handy for future reference. Take special care to follow the warnings indicated on the unit itself as well as in the operating instructions.

Safety

- Care of AC adaptor** - The cord of the AC adaptor should be routed so that they are not likely to be walked on or pinched by items placed upon or against them. Never take hold of the AC adaptor if your hand is wet, and always grasp the plug when connecting or disconnecting it.
- Disconnect when not in use** - When not in use, be sure to disconnect the AC adaptor from the AC power outlet.
- Batteries** - If the unit is not used for a long period of time or is used only from an AC power source, remove all the batteries to prevent potential damage due to battery leakage. Do not mix (old and new) batteries or different types of batteries.

Installation

■ Environment

- Condensation** - Moisture may form on the lens in the following conditions...
 - immediately after a heater has been turned on.
 - in a steamy or very humid room.
 - when the unit is suddenly moved from a cold environment to a warm one. If moisture forms inside this unit, it may not operate properly. To correct this problem wait about one hour for the moisture to evaporate.

■ Placement

- Foreign Material** - Care should be taken so that objects do not fall into and liquids are not spilled into the unit. Do not subject this unit to excessive smoke, dust, mechanical vibration, or shock.
- Magnetism** - The unit should be situated away from equipment or devices that generate strong magnetic fields.
- Stacking** - Do not place any objects on top of the unit.

- CLASS 1 LASER PRODUCT
- DANGER:** Invisible laser radiation when open and interlock failed or defeated. Avoid direct exposure to beam.
- CAUTION:** Do not open the top cover. There are no user serviceable parts inside the Unit; leave all servicing to qualified service personnel.

Maintenance

(See page 8 for details.)
Clean the cabinet, panel and controls with a soft cloth lightly moistened with mild detergent solution.
Do not use any type of abrasive pad, scouring powder or solvent such as alcohol or benzine.

Service

- Damage Requiring Service** - The unit should be serviced by qualified service personnel when:
 - (a) The AC adaptor is damaged; or
 - (b) Objects have fallen or liquid has been spilled into the unit; or
 - (c) The unit has been exposed to rain; or
 - (d) The unit does not appear to operate normally or exhibits a marked change in performance; or
 - (e) The unit has been dropped, or the enclosure damaged.

WARNING:

TO REDUCE THE RISK OF FIRE OR ELECTRIC SHOCK, DO NOT EXPOSE THIS APPLIANCE TO RAIN OR MOISTURE.

CAUTION!

THIS PRODUCT UTILIZES A LASER. USE OF CONTROLS OR ADJUSTMENTS OR PERFORMANCE OF PROCEDURES OTHER THAN THOSE SPECIFIED HEREIN MAY RESULT IN HAZARDOUS RADIATION EXPOSURE. DO NOT OPEN COVERS AND DO NOT REPAIR YOURSELF. REFER SERVICING TO QUALIFIED PERSONNEL.

POWERED BY NICKEL-CADMIUM BATTERY. MUST BE RECYCLED OR DISPOSED OF PROPERLY.

ATTENTION:

The product that you have purchased is powered by a rechargeable battery. The battery is recyclable. At the end of its useful life, under various state and local laws, it may be illegal to dispose of this battery into the municipal waste stream. Check with your local solid waste officials for details in your area for recycling options or proper disposal.



Ni-Cd



CAUTION!

This equipment has been tested and found to comply with the limits for a Class B digital device, pursuant to Part 15 of the FCC Rules.

These limits are designed to provide reasonable protection against harmful interference in a residential installation. This equipment generates, uses and can radiate radio frequency energy and, if not installed and used in accordance with the instructions, may cause harmful interference to radio communications. However, there is no guarantee that interference will not occur in a particular installation. If this equipment does cause harmful interference to radio or television reception, which can be determined by turning the equipment off and on, the user is encouraged to try to correct the interference by one of the following measures:

- Reorient or relocate the receiving antenna.
- Increase the separation between the equipment and receiver.
- Connect the equipment into an outlet on a circuit different from that to which the receiver is connected.
- Consult the dealer or an experienced radio/TV technician for help.

Any unauthorized changes or modifications to this equipment would void the user's authority to operate this device.

Cautions

Listening precautions



Do not play your headphones or earphones at a high volume. Hearing experts advise against continuous extended play.

If you experience a ringing in your ears, reduce volume or discontinue use.

Do not use while operating a motorized vehicle. It may create a traffic hazard and is illegal in many areas.

You should use extreme caution or temporarily discontinue use in potentially hazardous situations.

Even if your headphones or earphones are an open-air type designed to let you hear outside sounds, don't turn up the volume so high that you can't hear what's around you.

Sound can be deceiving. Over time your hearing "comfort level" adapts to higher volumes of sound. So what sounds "normal" can actually be loud and harmful to your hearing.

Guard against this by setting your equipment at a safe level BEFORE your hearing adapts.

To establish a safe level:

- Start your volume control at a low setting.
- Slowly increase the sound until you can hear it comfortably and clearly, and without distortion.

Once you have established a comfortable sound level:

- Set the dial and leave it there.

Rechargeable batteries

- Only the BN-R1211J battery can be recharged.
- If the power delivered by the batteries lasts for a very short time after recharging, it means that the batteries' service life is over. Do not use them any more.
- Recharging already charged batteries will shorten their service life.
- When recharging batteries for the first time or when they have not been used for a long period of time, the play time may be shorter than usual. In a case like this, repeatedly recharge and discharge the batteries. This will restore them to their regular state.
- Do not allow any metal objects to touch the terminals of rechargeable batteries since this may cause short-circuiting which is dangerous.
- Do not peel off the plastic covering on the rechargeable batteries. Short-circuiting may occur which is dangerous.

Dry cell batteries / rechargeable batteries

To prevent damage to the batteries and electrolyte leakage, heed the following points.

- Align the ⊕ and ⊖ polarities properly when inserting the batteries.
- Do not mix different types or makers of batteries or old and new batteries.
- Remove the batteries if you do not plan to use the unit for a long period of time.
- Do not throw batteries into a fire, and do not short-circuit, disassemble or subject them to excessive heat.
- Do not attempt to recharge dry cell batteries.

Carrying dry cell batteries / rechargeable batteries around

When putting dry cell or rechargeable batteries in a pocket or bag, ensure that no other metal objects such as a necklace are placed together with them. Contact with metal may cause short-circuiting which, in turn, may cause a fire.

When purchasing rechargeable batteries

As a safety precaution, the portable CD players made by JVC have a construction designed to make it impossible to recharge ordinary batteries.

To use rechargeable batteries, be absolutely sure to purchase the rechargeable Ni-Cd batteries designed especially for this unit.

Special rechargeable Ni-Cd batteries:

BN-R1211J (set of 2)

For details, check with your dealer.

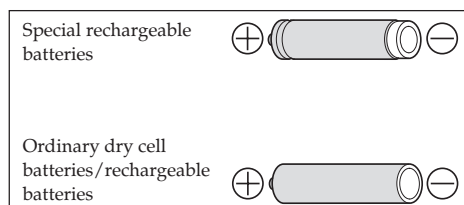

CD PLAY

Basic Play

Follow the steps in the numerical order.

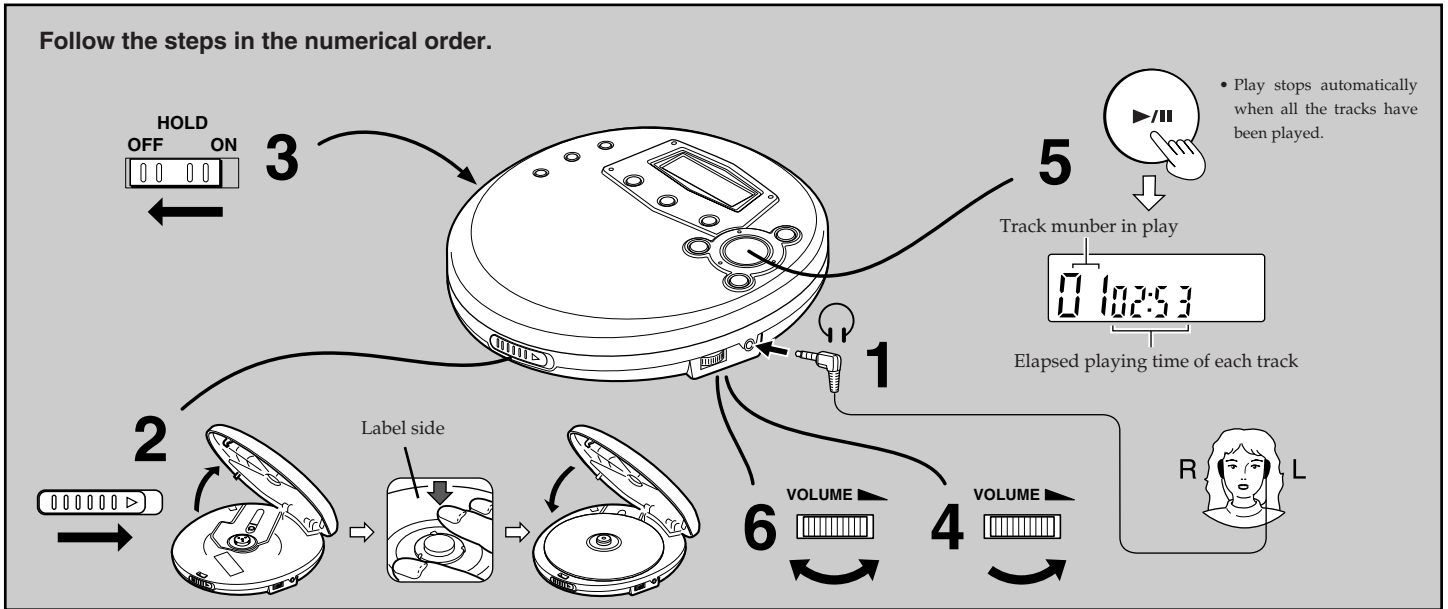

Operation	Button	Display/reference
To pause play	During play,	 Press again to resume play.
To stop play Stop mode	During play,	Total number of tracks Total playing time.
To turn off the unit	In stop mode,	
Fast forward/ reverse	During play, Forward Reverse Search function Keep depressed during play.	<ul style="list-style-type: none"> To skip back to the previous track, quickly press twice. During Program play, the button is used to fast forward or back through the programmed sequence of tracks. During Random play, the skip button cannot be used to skip back to tracks that were played previously in the random sequence.

For your reference:

"d 1 5 E"

This indication appears if is pressed when no disc is loaded in the unit or if the disc is not properly seated.

"_ _"

• Preparation period before playing the track
Flashes for several seconds after pressing to play.

"OP ER"

This indication appears when the lid is open.

Removing discs

Turn off the unit and, after the disc has stopped rotating, remove the disc as shown below:

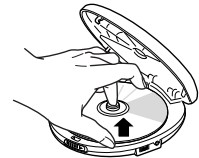

Auto power off function

If the unit is left in stop mode for 30 seconds, the unit turns itself off automatically to prevent the batteries from running down.

Other Play Methods

Intro play

You can successively play the first 10 seconds of every track. Intro play stops after playing the last track.

1 During playback,

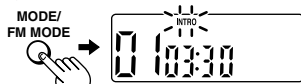

(Repeatedly)

2



The Intro play will start from the first track.

To cancel

Press MODE/FM MODE repeatedly until "INTRO" goes out.

To normally play the track being played

Press play/pause during Intro play.

Notes:

- In step 2, pressing play/pause instead of play/pause will start Intro play from the next track. Also, pressing play/pause will start Intro play from the current track. When no button is pressed, Intro play will start from the next track after the current track has finished.
- You can also select Intro play in stop mode.
- You can also select Intro play during Program play.

Random play

You can play all tracks in a random order. After playing all tracks, the unit stops.

During playback,



(Repeatedly)

To cancel

Press MODE/FM MODE until "RANDOM" goes out, or press stop to stop.

Notes:

- You can also select Random play in stop mode.
- During Program play, you can not select Random play.

Program play

You can program up to 20 tracks in any desired order including the same tracks.

1 During playback or in stop mode,

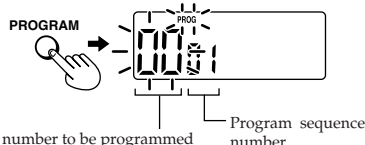

Track number to be programmed
00: Not programmed yet.

2 Select the desired track.

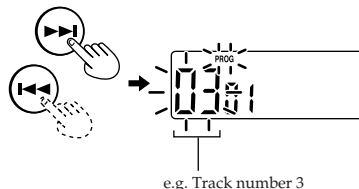

e.g. Track number 3

3

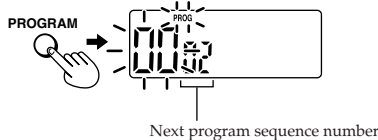

Next program sequence number

The track is registered.

4 Repeat steps 2 and 3 to program other tracks.

When you program exceeding 20 tracks, the program sequence number returns to "01" and will overwrite the previous setting.

5



The tracks are played in the programmed order.

• To confirm the program

In stop mode, press PROGRAM repeatedly. The programmed track number will successively appear together with the program sequence number. At this time, you can change the program, if required.

If the programmed tracks are less than 20, track number "00" appears for the youngest programmable sequence number, enabling further programming.

• To delete the entire program

Turn off the unit, or set the track number to 00 for the first program sequence number, "01".

Repeat play

You can repeat one track or all tracks.

During playback,

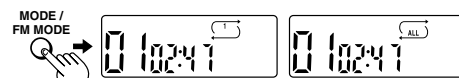

(Repeatedly)

To cancel

Press MODE/FM MODE repeatedly until the repeat indicator goes out.

Notes:

- You can also select Repeat play during Program play.
- You can also select Repeat play in stop mode.

Hyper-Bass Sound effect

You can enjoy powerful bass sound.

To get the Hyper-Bass Sound effect

Set HBS switch to "ON".



To cancel

Set HBS switch to "OFF".

Anti-Shock Protection

This function minimizes sound interruption caused by vibrations, by utilizing audio data that has been stored in the memory ahead of time (up to 45 seconds worth).

Normally, the "ANTI SHOCK" indicator lights up on the display and the Anti-Shock Protection is in effect.



When the disc is played, as the audio data gradually stored in the memory, the "ANTI SHOCK" indicator changes as follows:

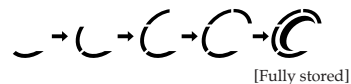

To cancel

Press the A.S.P. button in stop mode or during playback. The "ANTI SHOCK" indicator goes out.

To activate again

Press the A.S.P. button.

Notes:

- During Anti-Shock Protection operation, the disc rotates at a higher rate than usual in order to collect extra audio data. This may cause the batteries to run out faster and could result in a slight increase in disc rotation noise.
- The Anti-Shock Protection function can be switched ON and OFF during playback. However, this may cause a slight interruption in the sound because the disc's rotational speed changes.

Tuner Operation

You can listen to FM and AM stations by tuning in manually, automatically, or using preset memory.

For best reception, extend the headphone cord (FM antenna) for FM and turn the unit for AM.

Manual/Auto tuning

1 Select FM or AM.

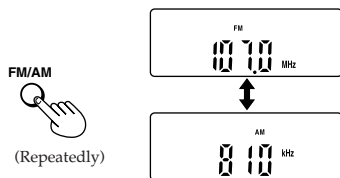

2 Select a station.

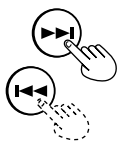

Manual tuning

Press ►► or ◄◄ repeatedly to select a station you want.

Auto tuning

Hold down ►► or ◄◄ for a while and then release it. The frequency automatically changes up or down to find the next station.

Preset tuning

Preset the stations beforehand.
(See "Presetting stations".)

1 Select FM or AM.

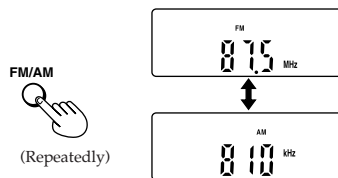

2 Select the preset number you want.

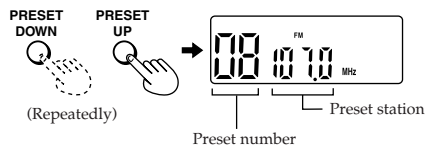

Presetting stations

You can preset up to 20 FM stations (frequencies) and 10 AM stations (frequencies).

1 Select the station you want to preset.

Use Manual or Auto tuning mentioned earlier.

2 Press PROGRAM.



3 Select the preset number you want.

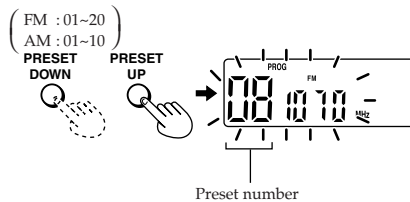

4 Press PROGRAM.

Changing the FM reception mode

When a broadcast is in stereo, "ST." lights up and you can hear stereo effects. However, if an FM stereo broadcast is hard to receive or noisy, you can select monaural (MONO) mode. Reception improves, but you lose the stereo effect.

To select the monaural mode

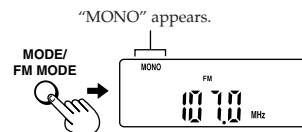

To restore the stereo mode

Press MODE/FM MODE once again. "MONO" will go out.

Notes:

The following operation will also restore the stereo mode.

- Pressing FM/AM
- Pressing ◄◄, ►►, PRESET UP, or PRESET DOWN
- Pressing ►/||
- Turning off the unit

Turning off the unit



Troubleshooting

Problem	Check this
Poor FM/AM tuner reception	<ul style="list-style-type: none"> • Change the direction of the unit for best AM reception. • Extend the headphone cord (FM antenna) to improve FM reception.
Does not turn on.	<ul style="list-style-type: none"> • Are the batteries charged? • Is the AC adaptor securely connected? • Is the HOLD switch set to OFF position?
Cannot close the lid.	Is the disc properly secured in place?
Cannot play discs.	<ul style="list-style-type: none"> • Is the disc properly secured in place? • Is there moisture condensation on the lens? (Wait for about an hour and then try again.)
Cannot hear music—too noisy.	<ul style="list-style-type: none"> • Is the headphone plug inserted all the way? • Is the plug dirty? (Wipe away dirt on the plug.)
TV picture is distorted. Other radio reception is noisy.	Are you using the unit too near a TV or other tuner? (If the TV or tuner is connected to a simple indoor antenna, connect it to an outdoor antenna.)
“diSC” or “Er” is displayed when a disc is in the player.	<ul style="list-style-type: none"> • Is the disc damaged? • Is the disc playable on this player? • Has the disc been inserted upside down?

If the remedies indicated in the chart do not solve the problem, refer to the directory of Authorized Service Centers (enclosed with this unit) to locate a convenient service center, or consult your dealer for instructions.

- When the unit malfunctions or freezes during use, disconnect the power source (the AC adaptor and batteries) once. Then, re-connect the power source and continue operation.
- If tuner operation is abnormal, reset the unit as follows.

1. Press the RESET switch twice.
2. Turn off the unit.
3. Turn on the unit.

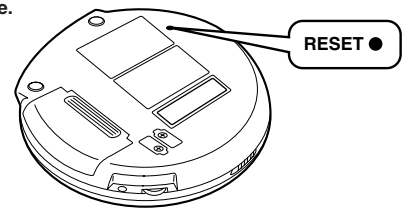

Note:

The preset broadcast stations you have made will be cleared by the reset operation.

Maintenance

Unit

Wipe the unit with a soft cloth. Remove stubborn dirt using a cloth which has been dipped in water or soapy water and wrung out, and then wipe dry.

- If you intend to use a chemically treated cleaning cloth, read its directions first.
- Do not use alcohol or paint thinners.

Lens

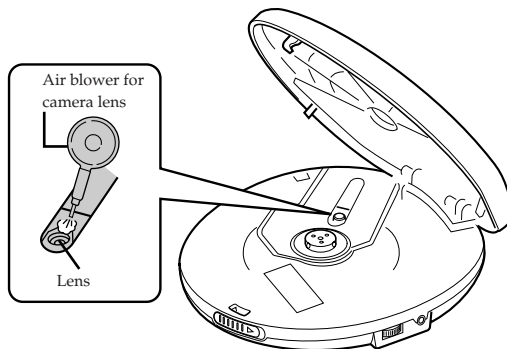

Specifications

Portable CD player

Type	: Compact disc player
Signal detection system	: Non-contact optical pickup (semiconductor laser)
Pickup system	: 3 beam laser
Number of channels:	: 2 channels (stereo)
Frequency response	: 20 Hz to 20 000 Hz
Wow & flutter	: Unmeasurable
Output	: Headphones (3.5 mm dia. stereo × 1) 9 mW/ch at 10 % THD/16 Ω matching impedance (16 Ω to 1 kΩ)
FM tuning range	: 87.5 MHz ~ 108.0 MHz
AM tuning range	: 520 kHz ~ 1 710 kHz
Duration of battery (with Anti-Shock Protection OFF)	: Approx. 3 hours when using two rechargeable batteries (BN-R1211) charged for 10 hours, Approx. 20 hours when using two alkaline batteries (LR6)
Power requirements	: DC 3 V (“AA” or “R6” size battery × 2) DC 2.4 V (rechargeable battery × 2) DC IN 4.5 V
Dimensions (W×H×D)	: 135.8 mm × 33.5 mm × 145.0 mm (5- ³ / ₈ ” × 1- ³ / ₈ ” × 5- ³ / ₄ ”) (Excluding buttons and controls)
Mass	: 250 g (0.56 lbs) (without batteries)

AC adaptor

Input power source	: AC 120 V, 60 Hz
Output voltage	: DC 4.5 V, 600 mA

* Design and specifications are subject to change without notice.